

MALE END VIEW

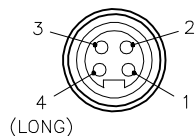

SPECIFICATIONS

HOUSING MATERIAL/COLOR	NYLON or PBT/BLACK
CONTACT MATERIAL/PLATING	BRASS/GOLD
COUPLING NUT MATERIAL/FINISH	STAINLESS STEEL/PASSIVATED
RATED CURRENT [A]	9.0 A
RATED VOLTAGE [V]	600 V
MAXIMUM WIRE SIZE	16 AWG
TERMINATION METHOD	SCREW TERMINAL
CABLE GRIP RANGE	PG11 = 8–10mm
TEMPERATURE RATING	–25°C to +85°C (–13°F to +185°F)
PROTECTION CLASS	IP67

EXPLODED VIEW

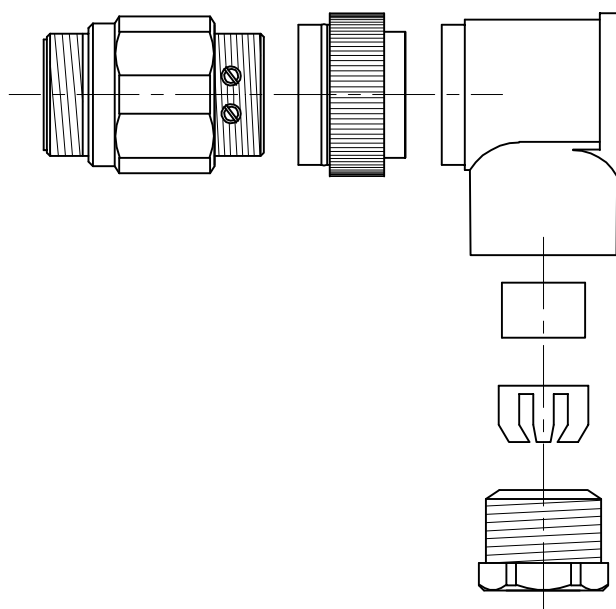

KEY-WAY
ADJUSTABLE
BY 45°
INCREMENTS

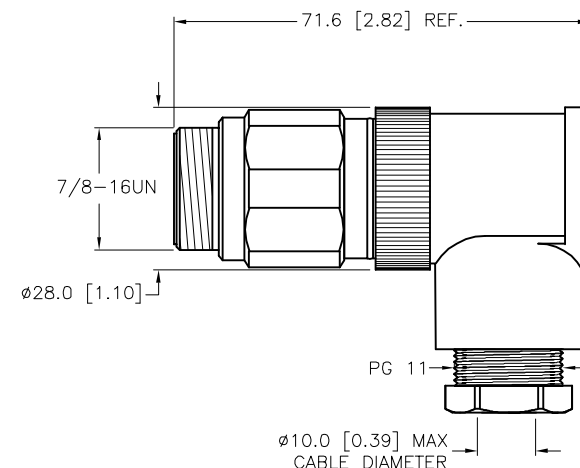
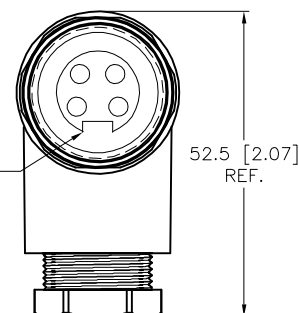

FIELD WIREABLE MINIFAST RIGHT-ANGLE CONNECTOR

SOURCE DRAWING – FOR REFERENCE ONLY

RELATED DOCUMENTS		3RD ANGLE PROJECTION		<div>THIS DRAWING IS CONFIDENTIAL AND THE PROPERTY OF TURCK INC. USE OF THIS DOCUMENT WITHOUT WRITTEN PERMISSION IS PROHIBITED.</div> <div>TURCK</div>		3000 CAMPUS DRIVE MINNEAPOLIS, MN 55441 1-800-544-7769 (763) 553-7300 (763) 553-0708 fax www.turck.us							
1.						DRFT		RDS	DATE		04/09/19	DESCRIPTION BSV 4241-0/11	
2.						APVD		L.S.	SCALE		1=1.3		
3.						UNIT OF MEASUREMENT MILLIMETER [INCH]							
4.				DO NOT SCALE THIS DRAWING						IDENTIFICATION NO.		REV	
MATERIAL		ALL DIMENSIONS DISPLAYED ON THIS DRAWING ARE FOR REFERENCE ONLY								U2-34242		A	
SEE SPECIFICATIONS													
FINISH													
SEE SPECIFICATIONS										FILE: U2-34242		SHEET 1 OF	